

# Stab-Lock Install Guide



Woodington Mill, Woodington Road,  
East Wellow, Romsey, Hants, SO51 6DQ  
Tel: +44 (0)1794 322884  
Web: [www.cpv.co.uk](http://www.cpv.co.uk)

### STEP 1

Cut pipe square to appropriate length and deburr ends.  
Note: Be certain pipe is visibly free of any dirt or debris. Acetone cleaner may facilitate the cleaning process. Chop saw or pipe cutting tool will ensure square cuts.

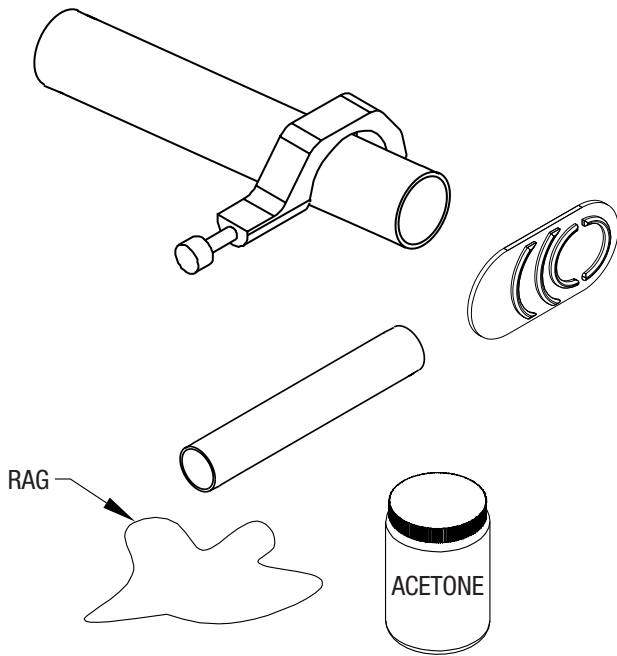

### STEP 2

Remove nuts from fittings.

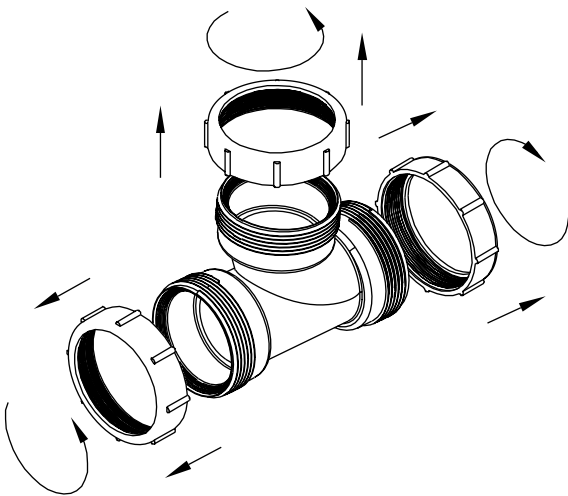

### STEP 3

Lubricate inside and outside of seal with petroleum jelly. Insert stainless steel ring and polyethylene seal into nut as shown.

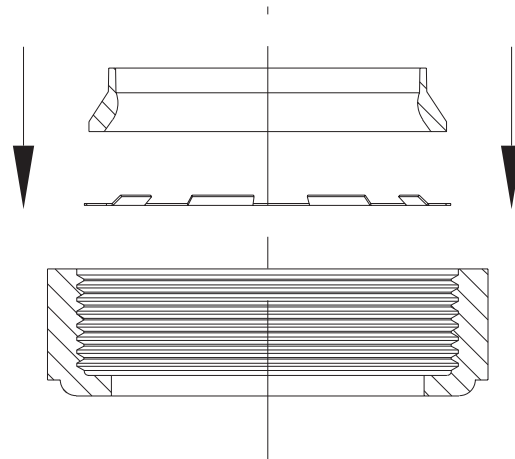

### STEP 4

Lubricate fitting threads with petroleum jelly and reapply nuts containing ring and seal. Handtighten the nuts.

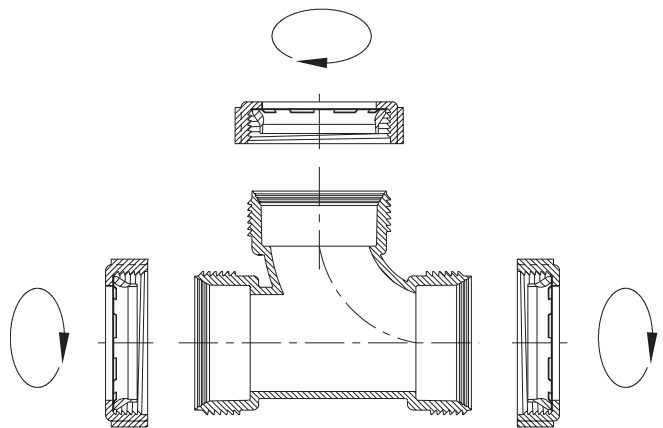

### STEP 5

Insert pipe into the joint assembly completely.

**Important:** Failure to insert pipe fully into the fitting could effect joint integrity.

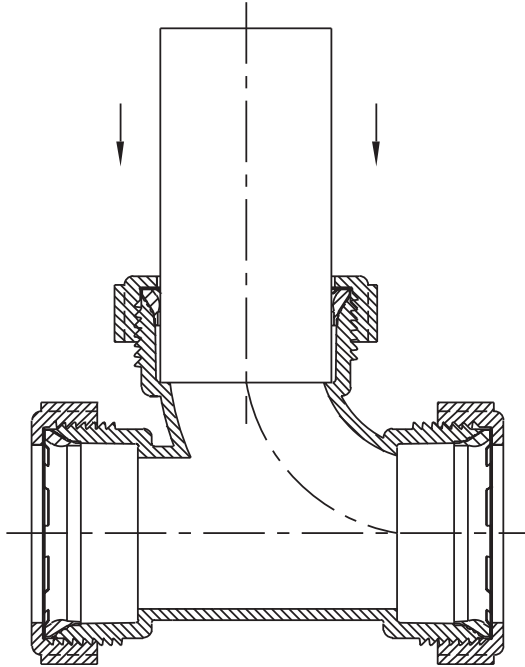

### STEP 6

With the Zurn spanner wrench, tighten nuts until snug.

